

SPEARHEAD

MULTICUT 470



Edition 1.2 – December 2020
Part No. 8999121

HANDBOOK

IMPORTANT

VERIFICATION OF WARRANTY REGISTRATION



DEALER WARRANTY INFORMATION & REGISTRATION VERIFICATION

It is imperative that the selling dealer registers this machine with Spearhead Machinery Limited before delivery to the end user – failure to do so may affect the validity of the machine warranty.

To register machines go to the Spearhead Machinery Limited web site at www.spearheadmachinery.com, log onto 'Dealer Inside' and select the 'Machine Registration button' which can be found in the Service Section of the site. Confirm to the customer that the machine has been registered in the section below.

Should you experience any problems registering a machine in this manner please contact the Spearhead Service Department on 01789 491867.

Registration Verification

Dealer Name:
Dealer Address:
Customer Name:
Date of Warranty Registration:/...../..... Dealer Signature:

NOTE TO CUSTOMER / OWNER

Please ensure that the above section has been completed and signed by the selling dealer to verify that your machine has been registered with Spearhead Machinery Limited.

IMPORTANT: During the initial 'bedding in' period of a new machine it is the customer's responsibility to regularly inspect all nuts, bolts and hose connections for tightness and re-tighten if required. New hydraulic connections occasionally weep small amounts of oil as the seals and joints settle in – where this occurs it can be cured by re-tightening the connection – refer to torque settings chart below. The tasks stated above should be performed on an hourly basis during the first day of work and at least daily thereafter as part of the machines general maintenance procedure.

CAUTION: DO NOT OVER TORQUE HYDRAULIC FITTINGS AND HOSES

TORQUE SETTINGS FOR HYDRAULIC FITTINGS

HYDRAULIC HOSE ENDS		
BSP	Setting	Metric
1/4"	18 Nm	19 mm
3/8"	31 Nm	22 mm
1/2"	49 Nm	27 mm
5/8"	60 Nm	30 mm
3/4"	80 Nm	32 mm
1"	125 Nm	41 mm
1.1/4"	190 Nm	50 mm
1.1/2"	250 Nm	55 mm
2"	420 Nm	70 mm

PORT ADAPTORS WITH BONDED SEALS		
BSP	Setting	Metric
1/4"	34 Nm	19 mm
3/8"	47 Nm	22 mm
1/2"	102 Nm	27 mm
5/8"	122 Nm	30 mm
3/4"	149 Nm	32 mm
1"	203 Nm	41 mm
1.1/4"	305 Nm	50 mm
1.1/2"	305 Nm	55 mm
2"	400 Nm	70 mm

MULTICUT 470

MULTICUT 470

Contents

Safety	6
Recommendations	7
Introduction	9
Tractor Requirements	9
Attaching To The Tractor	10
Setting Up Your Machine	12
Operation	15
Transportation	17
Machine Protection	18

Servicing & Maintenance

Safety First	19
Daily	19
Every 8 Hours	20
Regularly	20
Blades	21
Slip Clutch Settings	22
Skids	23
Storage	23
Trouble Shooting Guide	24

MULTICUT 470

MULTICUT 470

Safety



Warning
Avoid fluid escaping under pressure. Consult technical manual for services procedures.



Warning
Danger – flying objects keep safe distance from the machine as long as the engine is running.



Warning
Stay clear of mower blade as long as engine is running.



Warning
Stay clear of swinging area of implements.



Warning
Shut off engine and remove key before performing maintenance or repair work.



Warning
Check all nuts are tight every 8 hours.



Warning
Carefully read operator's manual before handling this machine. Observe instructions and safety rules when operating.

MULTICUT 470

Recommendations

Beware of the following Potential Dangers associated with the use of this machine:

- Becoming trapped when hitching or unhitching
- Machine overbalancing when wing is raised.
- Getting caught on rotating power take off (PTO)
- Being hit or caught by any moving part, e.g. Blades, drive shaft and wings.
- Being hit by flying debris or machine parts due to machine damage
- Machine overbalancing when not in use
- Injection of high pressure oil from damaged couplings or hydraulic hoses
- Accidents due to collision with other machines, or debris left on road
- Beware of free-swinging blades over centering and falling when wings are folding.

ALWAYS:

- Ensure the operator has read this handbook and has been trained to use the machine.
- Ensure all safety guards are in place and all tractor windows closed.
- Impact resistant shielding to the tractor is recommended
- Before leaving the tractor cab always ensure that the wings are firmly on the ground, no weight is on the machine's hydraulics and the rotor has stopped spinning.
- Check that all guards are properly fitted and there are no damaged or loose parts. Particular attention should be given to the blades to ensure they are not damaged, cracked or missing
- Inspect work area for wire, steel posts, large stones and other dangerous materials and remove before starting work.
- Ensure that all warning labels are always visible and that they are not damaged, defaced or missing.
- Fit locking pins to height and to wings before transport and before unhitching when applicable.
- Wear ear defenders if operating without a quiet cab or with the cab windows open
- Ensure tractor guards are fitted correctly and are undamaged
- Work at a safe speed, taking into account terrain, passing vehicles and obstacles
- Ensure that the tractor meets the minimum weight recommendations of the machine manufacturer and that ballast is used if necessary
- Check that machine fittings and couplings are in good condition
- Follow the manufacturer's instructions for attachment and removal of machine from the tractor
- Ensure blades are of the type recommended by the manufacturer, are securely fitted and are undamaged
- Ensure hydraulic pipes are correctly routed to avoid damage from chafing, stretching, pinching or kinking.
- Check condition of tyres and tightness of wheel nuts.

MULTICUT 470

Recommendations

- Ensure all blades have stopped spinning before folding wings into transport position.
- Disengage the machine, stop the engine and remove the key before leaving the tractor cab for any reason
- Clean up any debris left at the work site.
- Ensure that when you remove the machine from the tractor it is secured in a safe position using the stands provided.

NEVER:

- Never operate the machine with other people present, as it is possible for debris, including stones, to be discharged from the front and rear.
- Never operate the machine until you have read and understood this Handbook and are familiar with the controls.
- Never use a machine that is poorly maintained or has guards that are damaged or missing
- Never allow an inexperienced person to operate the machine without supervision.
- Never use or fit a machine onto a tractor if it doesn't meet the manufacturer's specification.
- Never use a machine if the hydraulic system shows signs of damage.
- Never attempt to detect a hydraulic leak with your hand, use a piece of card.
- Never allow children to play on or around the machine at any time.
- Never attempt any maintenance or adjustment without first disengaging the PTO, lowering the wings to the ground, stopping the tractor engine and applying the tractor parking brake.
- Never leave the cab without removing the ignition key.
- Never operate the tractor or any controls from any position other than from the driving seat.
- Never stop the engine with the PTO engaged.
- Never operate with blades missing.
- Never operate PTO above recommended speed, 1000 r.p.m.
- Never operate with wire around the rotor. Stop immediately.
- Never use the wing raised which may throw debris towards the cab.
- Never attempt to use the machine for any purpose other than that it was designed for.
- Never transport with the PTO engaged.
- Never enter the working area of the machine (risk of injury!).
- Never engage the P.T.O with wings folded.

MULTICUT 470

Introduction

The Spearhead 630 is a heavy-duty rotary mower for a set-aside, stubble and pasture topping. By carefully following the instructions in this handbook, the 630 will give many years of trouble free operation.

Safety First

Never start using the machine until the handbook has been read and understood. The 630 rotary mower is a potentially lethal machine if used incorrectly and it is essential that the operator fully understand the working before starting up.

Tractor Requirements

- Spearhead recommend tractors of between 85 and 150hp.
- A clevis drawbar must be used,
- The tractor should have a minimum weight of 3000 kg.
- The tractor should have a 1,000rpm P.T.O.
- Two external hydraulic services are required, double acting for height control and double acting for wings with float facility.

Attaching To The Tractor

It is essential to ensure that the tractor lift arms cannot foul the P.T.O. shaft, even when the tractor is on full lock. It is advisable to remove them altogether if there is any doubt.

The tractor drawbar should be extended to its maximum not less than 400mm from the P.T.O. This will enable turning in work without damaging the drive shaft. Never attach the mower using the pick-up hitch as this will cause damage to the drive shaft.

Fit the nylon washer between the mower drawbar and the tractor clevis, as shown, to reduce wear between the two parts. The nylon washer is a replaceable wearing part.

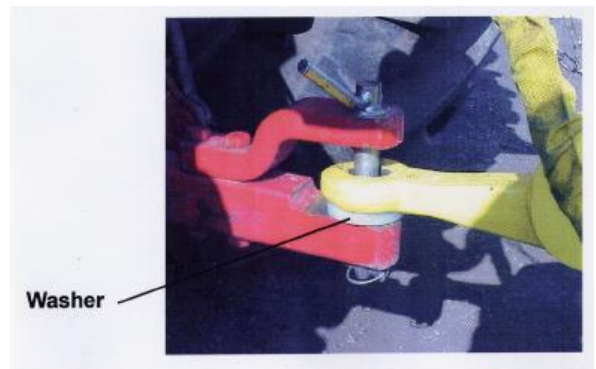

Warning

Do not attach machine to pick up hook. This will damage the P.T.O. shaft

MULTICUT 470

Attaching To The Tractor

Determining The Correct Length PTO Shaft

To determine the correct length of the driveline, it is advisable to hook the machine to the tractor and place the machine in order for it be at a minimum distance between the power takeoffs.

Install the two uncoupled and unprotected semi-shafts to their respective PTOs.

At this point, verify any interference of the outer tube with the yoke inner tube and establish how much the outer tube needs to be shortened.

Towed Machines

In towed machines, the minimum distance D_{min} between the joints occurs during steering.

Verify that, in the condition of maximum extension, which generally occurs when the machine is aligned,

the coupling between the two tubes is sufficient. When determining the minimum and maximum lengths and during subsequent verifications, it is important to bear in mind that ground subsidence may cause further reduction and increase of the distance between the PTOs.

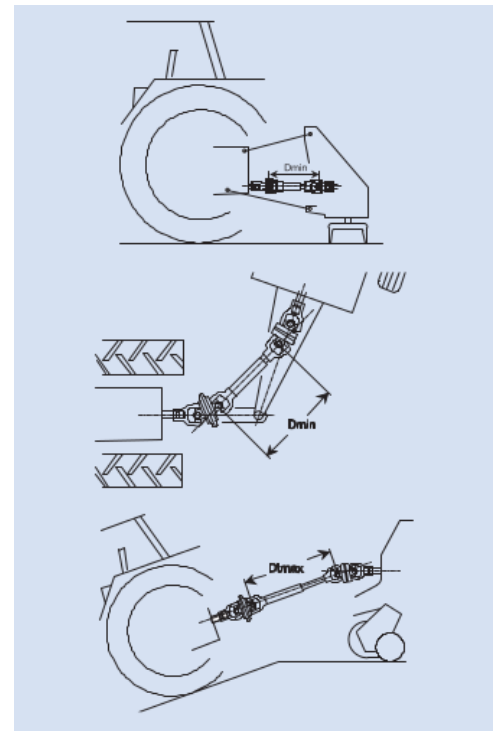

Bondioli & Pavesi does not recommend modifications to its products. If the driveline needs to be shortened, proceed as described below. If you are unsure of the procedure, or need additional assistance, please contact your local implement dealer or qualified service centre.



1. Remove shielding.
2. Shorten drive tubes by required length. In normal conditions, telescoping tubes must always overlap by at least a $\frac{1}{2}$ of their length. During manoeuvres, when the driveline is not rotating, the telescopic tubes must have a suitable overlap to maintain the tubes aligned and allow them to slide properly

If the driveline is fitted with a single chain restraint system (splined inner tube), the tubes can be shortened by a limited amount (normally no more than 70mm) to avoid eliminating the splined ring connecting the two shield tubes.

If the driveline is fitted with a greasing system incorporated in the inner drive tubes, the tubes can be shortened by a limited amount to avoid damage to the lubrication system. Carefully measure and shorten each drive tube equally.

MULTICUT 470



3. Carefully deburr the ends of the tubes with a file and remove any chippings from the tubes



4. Shorten shield tubes one at a time by cutting the same length that was cut from the drive tubes. If the driveline is equipped with Single Chain Restraint System, shortening the driveline will involve removal of the plastic ring which connects the shield tubes. If it is necessary to remove this collar, ADD A RETAINING CHAIN TO THE TRACTOR SIDE OF THE DRIVELINE SHIELD.



5. Grease the internal drive tube. Reassemble the shield on the driveshaft.

ATTENTION: SFT drivelines with 4-tooth profiles must be reinstalled in such a way that the grease fittings on the cross kit bearings are aligned.



6. Check the length of the driveshaft at the minimum and maximum positions of the machine. Telescoping tubes must always overlap by at least a $\frac{1}{2}$ of their length. During manoeuvres, when the driveline is not rotating, the telescopic tubes must have a suitable overlap to maintain the tubes aligned and allow them to slide properly.

MULTICUT 470

Setting Up Your Machine

Levelling – Front To Rear

Once coupled to the tractor, check the mower is cutting level from the front to the rear of the machine. This is important to ensure each rotor will cut at the same height.

1. Set-Up On Hard, Level Ground – Adjusting Tie Bars

Levelling the front to rear of the machine should be carried out on a level concrete surface with the front of the machine being 1 inch (25mm) higher than the rear.

Measuring

One of the easiest ways to determine the height of the front and rear of the machine is to measure from each end of the top of the hinge bar to the ground. Measurements need to be taken from the same side of the machine.

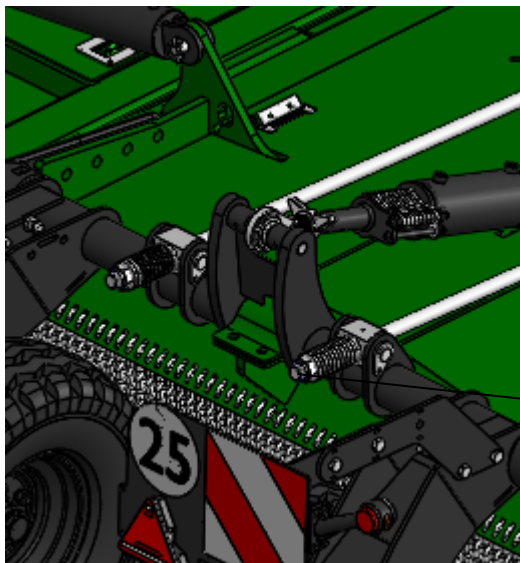
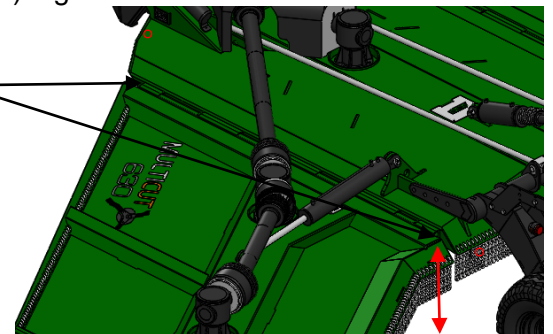

Adjustment To Height

The machine has adjustable tie bars that can be lengthened to lower the front or shortened to raise the front by then turning the nylock nut (1) accordingly.

These tie bars need to be adjusted equally.



Keep in mind that the tyres may sink in soft conditions when the machine is in use altering the actual cut height. As a safe precaution, set the cutting height slightly higher on set-up to cater for this sinking. Assess the working area after and then adjust again if required.

MULTICUT 470

Levelling – Wings LH & RH

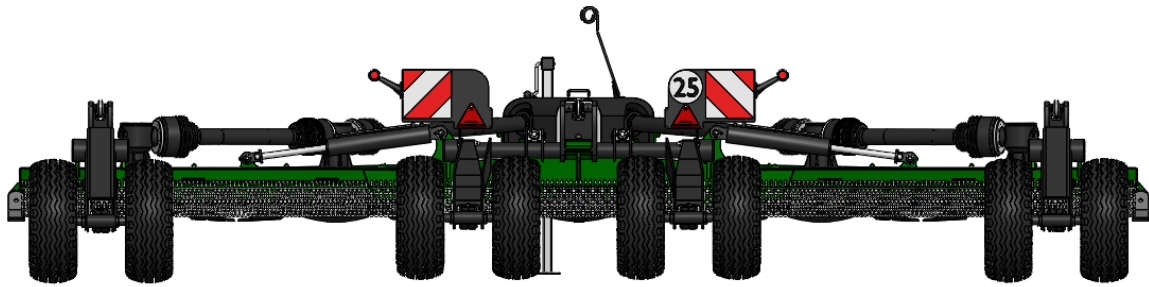

This is most critical with low cutting heights (75mm and below). Machines roll in work due to ground contours, softer ground supporting the wings and suspension give. It is advisable to prevent regular and excessive contact of particularly the wing blades and anti-scalp disk with the ground. This can cause:

- Significantly faster wear of blade, anti-scalp disk and skids
- The additional load can lead to premature clutch wear and gearbox failures

With the machine in the working position and the wings folded down it may be necessary to alter the height of the wing to ensure each rotor is cutting level. There are several ways of adjusting the wing height on a Spearhead 630 mower. These adjustments are necessary to compensate for wear and also variation of tolerances. We recommend the wings are set 12 – 25mm ($\frac{1}{2}$ " – 1") higher than the centre chassis, to maintain a level cut. Generally the machine is with the wings $\frac{1}{2}$ inch (12mm) higher than the centre section.

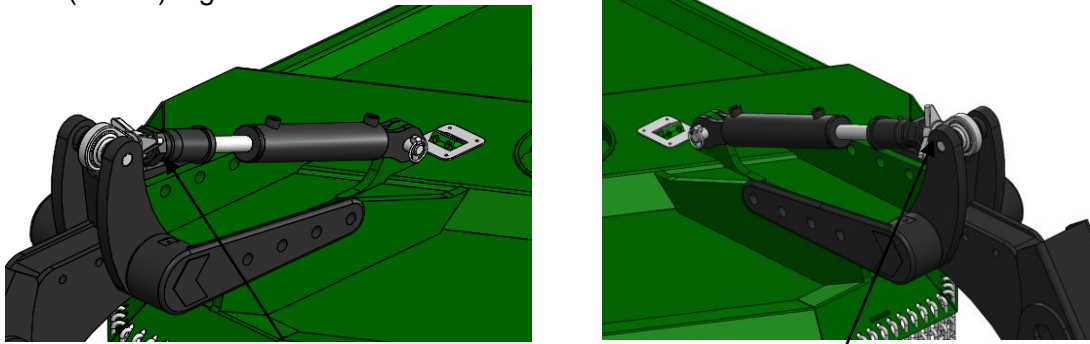

Fine Adjustment

Fine adjustment is made by releasing the locking nut and using the turnbuckle located between the axles. Lengthen to lower the wing, shorten to raise the wing. Retighten the locking nut.

(Note do not expose more than 25mm of thread as the ball ends will foul in the clevis when fully lowered)

After making adjustments to the machine and before re-measuring and rechecking working heights, shunt the machine backwards and forwards a couple of times to ensure suspension and all pivots are settled into the working positions.



Warning

The machine is set at the factory with the centre deck 1" (25mm) higher at the front and the wings $\frac{1}{2}$ " (12mm) higher to the centre section, when mounted on the tractor drawbar at 16" (400mm).

When operating over uneven ground it is recommended to raise the front of the machine by adjusting the tie bars to prevent scalping or damage to the blades.

MULTICUT 470

Setting Up Your Machine

Height

To alter the minimum height of cut; fully raise the machine, remove all stops from the ram and gently lower the machine. To increase the height of cut, add stops/spacers by fully lifting machine add the spacers required and then gently lower the machine onto the stops.

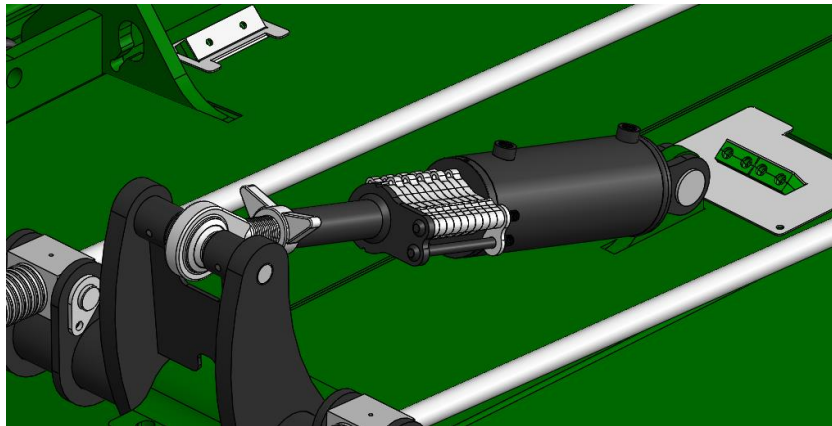

Wings

To unfold the machine remove the ratchet strap and then pressurize the wing rams to unfold the machine, once the wings have folded over centre then place the rams into float.

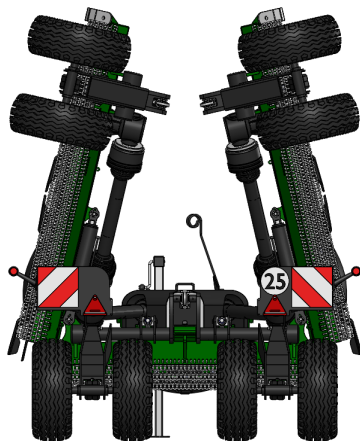

To fold the machine for transport pressurize the wing rams to fold them up and then once they have gone over centre continue until the rams are fully closed. Once fully closed then fit the ratchet strap.

MULTICUT 470

Operation

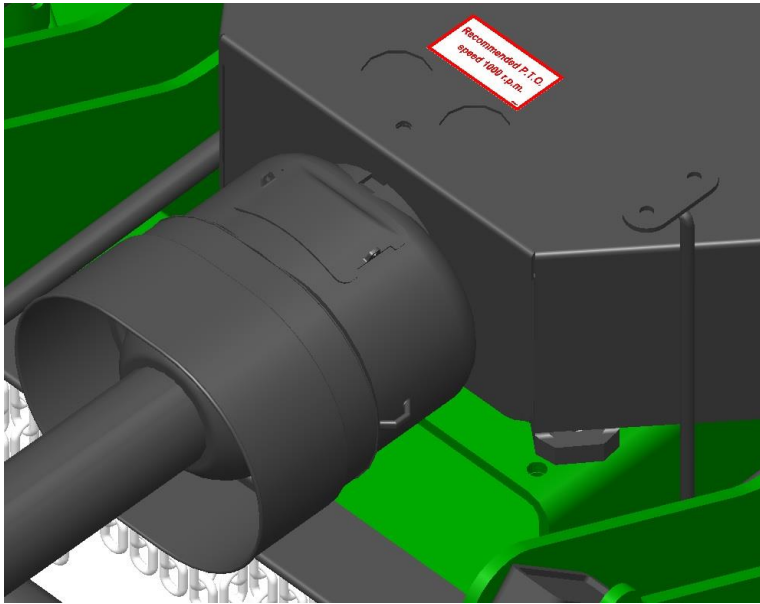

Once ready for work, raise the mower cutting height and slowly engage the PTO with the tractor engine at low revs to prevent shock damage to the machine. Slowly increase the engine revs to achieve the recommended PTO speed of 1000r.p.m. As indicated by the decal on top of the centre guard and not the number of splines on the P.T.O shaft. If at any

time serious vibration occurs, **stop the engine immediately and check the blades, following all safety precautions.** Select a sensible forward speed bearing in mind the density of growth, the terrain, and the available horsepower.



The quality of finish is determined by the forward speed, i.e. a slow speed will produce a high quality of cut, where as faster forward speeds are used when high output is first priority.

When in work, always ensure the hydraulic spool valve that operates the folding of the wings is in float position to enable the wings to freely follow all contours of ground (Fig. 6).

Fig. 6 contours of the ground

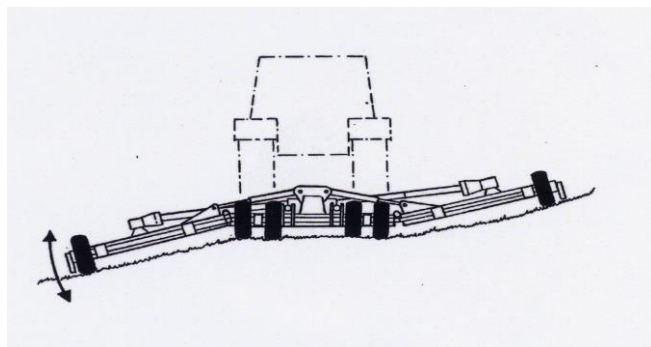

MULTICUT 470

Recommended

Whilst operating it is possible to continue working when turning as the 630 Rotary Cutter is fitted with a constant velocity joint on PTO shaft. However take care not to run the rear tractor wheel against the mower draw bar as this will result in serious damage to the tractor, the mower and, in particular, the PTO shaft.

The wide angle joint on the input PTO shaft, allows the PTO to be left in gear whilst turning out of work, e.g. on the headlands. **It is important not to turn sharply when the machine is in work as this will over-strain and shorten the life of the drive shaft.**

When operating in confined areas it is possible to cut going backwards, but it is advisable to slightly raise the machine, particularly if in scrub, where there is the risk of hitting hidden solid obstacles obscured by dense undergrowth.

Always exercise particular care when operating over uneven ground surfaces. Do not allow the blades and blade holder to frequently hit the ground.

Do not allow debris to build upon the cutting decks in dry conditions, as this can be a fire hazard, in wet conditions it will place unnecessary strain on the machine and may foul the drive shaft causing damage.



Warning

Do not run the machine with the wings raised. The risk of debris and machine parts being ejected is greater as the chain skirting is ineffective in this position.

MULTICUT 470

Transportation

First disengage the PTO drive, fold the wings fully up and secure with transport strap (Fig. 7). Raise the machine up and fit 8-10 of the height stops and then drop weight of machine back onto ram.

Please observe Public Highway Regulations, concerning the towing of implements, and securely attach a registration and lighting board.

Transportation Position

Transport Strap

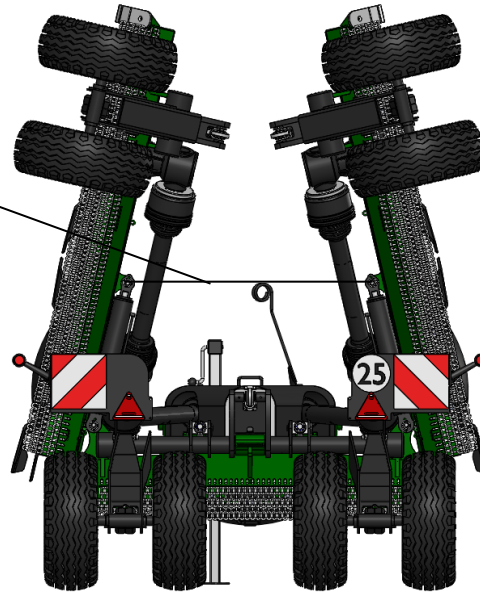

Note

Before parking and unhitching your machine please lower the height ram onto its stop to relieve the hydraulic pressure, before releasing to hoses. Observe Public Highway Regulations, concerning the towing of implements, and securely attach a registration and lighting board.



Warning

Avoid transporting machine at high speed over rough ground
Maximum speed on highway – 20mph (25kph).

MULTICUT 470

Machine Protection

To prevent gearbox damage all rotors are protected by slip clutches fitted to each of the five drive shafts. When cutting in extreme conditions where stumps, rocks and other such solid objects are likely to be found it is recommended that the operator reduces the engine revs to allow the blades to pivot more easily when striking solid objects, fit stump jumper plates to lower blade carriers, and proceed with caution.

The clutch settings should not be altered without reference to Service and Maintenance. Never over-tighten the pressure springs on the slip clutches (Fig. 8) as this could result in severe damage to the gearbox and drive lines, as well as invalidating the warranty.

If the machine has been laid up for any length of time, there is a risk of the clutch plates rusting and seizing together. Never operate the machine in this condition, as there will be no protection to the driveline and gearboxes against shock loading. To free the clutch plates first slacken all pressure spring bolts and run up the machine for a short period, deliberately try to cause the clutch to slip. Finally re-tighten the tension spring bolts to their original length, taking great care not to over-tighten. Alternatively refer to page 26.

If in any doubt, consult Spearhead's Service Department or your local Spearhead Dealer for further advice.

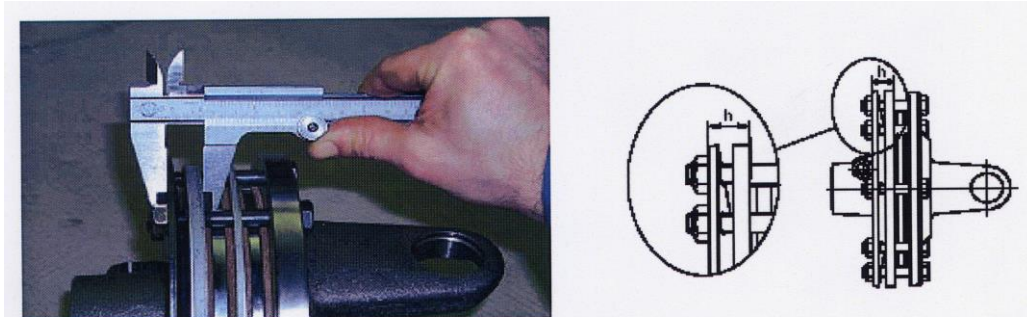

Fig. 8 Slip Clutch (BONDIOLI & PAVESI)

MULTICUT 470

Service & Maintenance

Safety First

- Never leave the tractor seat without first disengaging the PTO and stopping the engine.
- Ensure all rotating parts have stopped turning.
- Never attempt any repairs, maintenance, service or any other checks with the machine carried on the tractor hydraulics.
- Always fully lower to the ground, or securely prop the machine on substantial servicing stands.
- Always replace all guards and retaining chains after servicing/maintenance completed.

It is imperative that the following checks are carried out in order not to invalidate your warranty; these are carried out **before the first operation, after the first hour, then after 4 hours.**

These checks are:

1. Wheel nuts and tyre pressure (23.2psi).
2. Gearbox bolts, including the splitter box.
3. Oils in all the 4 gearboxes.
4. Blade bolts are fully tightened and in particular the 3 castle headed nuts on the 3 blade rotors.
5. Retaining bolts on the drive shafts.
6. Grease all points including drive shaft tubes
7. After the first 50 hours drain and replace the gearbox oil.
Replace Splitter gearbox oil with EP80-90W or GL-4/GL-5 gear oil.
Replace Rotor gearbox oil with 85W-140 gear oil.



Warning

Never carry out any servicing or maintenance work without first disengaging the PTO and then stopping the tractor engine before leaving the seat.

On delivery of your machine check that the dealer has completed the P.D.I form, ensure the warranty registration form is completed and returned.

MULTICUT 470

Service & Maintenance – Every 8 Hours

Fig. 10
Primary input shaft.

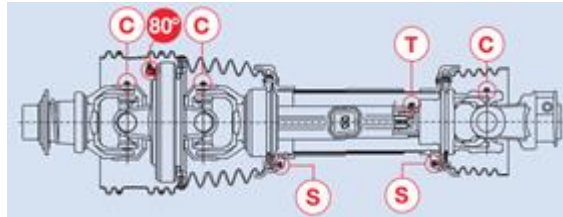

	S8
Cross (C)	22 g
Shield Bearings (S)	6 g
Telescopic Members (T)	32 g
80° CV-joint (80°)	80 g

- For maximum life and performance, the CV body must be greased regularly. Lubricate with the driveline in a straight position - up to 30 pumps of grease may be required.
- The metal drive tubes must be greased to operate properly.
- Shielding is subject to damage from abuse and weathering. Replace all damaged components and all shielding removed during maintenance.
- Do not use PTO adapters with CV drivelines. Replace special taper pin bolts only with genuine OEM parts, periodically check tightness of nuts.

- Dismantle and clean the main input P.T.O shafts sliding surfaces and re-grease; failure to do this will result in serious damage to the splitter gearbox.
- Grease all universal joints, (Fig. 10) paying particular attention to the constant velocity joint. If under-greased this constant velocity joint will soon fail.
- Grease the wing drive shaft tubes, (note the hole in the plastic tubing for access).
- Lubricate the retaining collar on all the drive shaft guards (Fig. 10).
- Grease PTO inner tube and push pins (Fig. 10).
- Check all bolts are tightened to the correct Torque (Fig.11).

MULTICUT 470

Servicing & Maintenance

Regularly

- Check there is no wrapping of string, plastic, grass or other debris between rotor boss and gearbox oil seal.
- Inspect gearbox seals for leaks.
- Clear grass and other debris from the deck.
- Regularly check the rotor boss retaining castle nut for tightness. First remove the split pin, select the correct size socket in 3/4" drive and fully tighten the nut. When replacing the split pin, do not slacken the nut to align the hole, always tighten. Failure to regularly check this nut will result in serious wear to hub, which is expensive to repair.
- **It is most important that all gearbox bolts are regularly checked to be very tight. When the machine is new there will be a 'bedding in' period where very frequent checking is important.**



Warning

When operating in dry conditions keep upper decks, clear of debris is reduce the risk of fire.

Blades

Caution! When carrying out maintenance work on or near the blades be careful of free-swinging blades over-centering and falling. It is recommended that protective clothing including hardhat and goggles are worn.

The blades can be re-sharpened by grinding the cutting edges, care must be taken that the blades are of the same weight and length after grinding. Do not overheat when grinding, as this will affect the hardness of the blades. All the blades are free swinging and swivel on hardened steel bushes, which are replaceable. When replacing blades, it is important that blades are replaced in sets, in order to retain balance of the rotor. Bushes must be replaced when new blades are to be fitted.

If the blades are showing any signs of severe wear, damage or cracking, they must be replaced immediately. Never attempt to weld the blades, as this will make them very brittle thus extremely dangerous. Do not take risks with the cutting blades - if in doubt, replace.

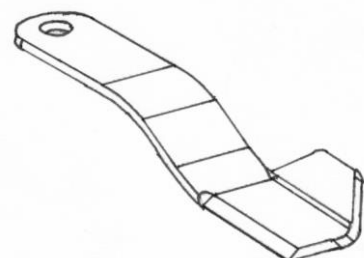

MULTICUT 470

Clutch Maintenance & Settings

BONDIOLI Manufacture (Belleville Spring)

Check the condition of the friction discs before use and following periods of storage. Release the tension from the spring, turn the clutch while holding the P.T.O stationary. Adjust the spring compression to the original setting.

Following seasonal use, unload the spring tension and store clutch assembly in a dry place. Check condition of friction linings and reset spring compression to original height before use.

Should the assembly overheat due to frequent or prolonged clutch slipping, dismantle for inspection. The original thickness of the lining is 3.2mm, replace them when worn to 2.5mm. Clean up all contact surfaces and replace any damaged components before assembly.



Warning

The slip clutch is there to protect the gearbox. If the blades strike a large obstacle they may get damaged or break - avoid these conditions.

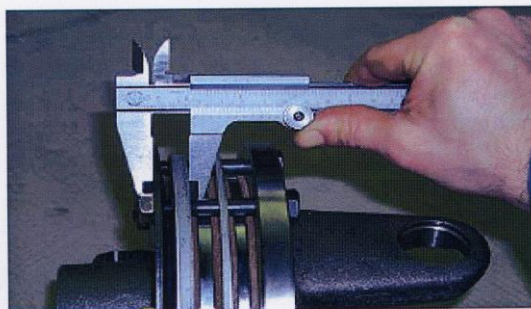

Fig 1

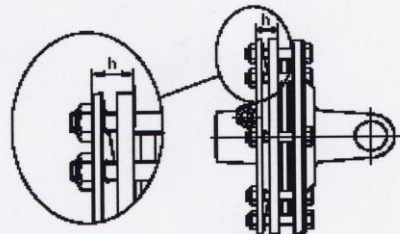

Fig 2

Standard - 3 Blade Per Rotor

Fig No.	Position.	Part No.	Setting.	Machine.
2	Centre (2 plate)	5770601	19.0mm	470 (1000rpm)
2	Wing (2 plate)	5770602	18.5	470 (1000rpm)

Note

The dimensional setting 'h' applies to later type clutches where the 2 discs being measured are of equal diameter.

MULTICUT 470

Servicing & Maintenance

Skids

When operating on abrasive soils, particularly in stubbles and similar conditions with thin ground cover, excessive skid wear may be expected. To provide extra protection and to prolong life of the skids, special hard facing rods are available.

Storage

Before storing away, thoroughly wash the machine removing all traces of grass and dirt. Great care must be taken when washing with high-pressure hoses, do not hold the water jet close to the paintwork. Use steam cleaners with caution and be sure to remove all detergents to avoid any discoloration or damage to the paintwork.

Grease all grease points until fresh grease shows. Liberally apply used engine oil along the whole length of the hinges of each wing section. The centre clutch coupling and wing shafts must be removed and stored under cover. Smear grease on the chrome ramrods for protection

After Storage

Disassemble clutches and with an emery cloth remove all traces of rust on the metal clutch plates. Check condition of the friction plates, if there is any sign of over heating, wear or cracking, replace with new. Do not attempt to use the machine with damaged slip clutch plates.

Reassemble the clutch units and tighten the bolts to achieve the correct spring length. Do not over tighten or the clutches will not work.

Check condition of tyres and pressure then follow the maintenance procedure covered in the servicing part of this manual. Pay particular attention to the condition of guards and blades.

Remember the *470 Rotary Cutter* is designed to withstand the most rigorous conditions and, with a little care and attention, will give many years of trouble free service. So as not to invalidate the warranty and to avoid problems, use only genuine parts and make sure the machine is not driven at a speed in excess of 1000r.p.m. on the PTO.

MULTICUT 470

Trouble Shooting Guide

Broken or damaged blades

1. Raise cutting height to avoid striking the ground
2. Remove or avoid obstacles such as rocks
3. Check rotor speed
4. Ensure a steady feed into drive (Do not snatch the PTO)
5. Fit optional stump jumpers

Damaged blade holder

1. As above
2. Failure to keep tight centre retaining nut

Damage gearboxes

1. Seized slip clutch.
2. Telescopic shafts bottoming out
3. Engaging drive with too much power / revs
4. Lack of grease on sliding tubes of drive shaft

Damage to PTO shaft

1. Seized slip clutch
2. Telescopic tube bottoming out
3. Engaging drive with too much power / revs
4. Turning too sharp
5. Not enough overlap
6. Lack of grease
7. Build up of Debris under drive shaft

Gearbox overheating

1. Incorrect oil level
2. Incorrect grade of oil
3. Incorrect operating speed
4. Machine overloaded
5. Rubbish around the gearbox reducing air circulation

Slip clutches overheating

1. Machine overloaded
2. Incorrect operating speed
3. Incorrect setting
4. Blades hitting the ground

Oil leak from gearbox

1. Damaged shaft seal check for foreign matter (wire-string)
2. Faulty breather
3. Damaged gasket
4. Incorrect oil level

Metal fatigue on frame

1. Too fast a traveling / operating speed for conditions
2. Wings not floating i.e. following the ground contours (check tractor spool)
3. Used in a manner or condition contra to its intended purpose

Excessive skid wear

1. Set skids above the ground

Spearhead Machinery
Station Road
Salford Priors
Evesham
Worcestershire
WR11 8SW

Tel: 01789 491860

Fax: 01789 778683

www.spearheadmachinery.com
enquiries@spearheadmachinery.com